

# Mounting instructions

Vertical ladder systems

---

**Vertical ladder systems**

*Mounting instructions*

## Table of contents

<b>1</b>	<b>About these instructions</b>	<b>4</b>
1.1	Target group	4
1.2	Relevance of these instructions	4
1.3	Types of warning information	4
1.4	Basic standards and regulations	4
1.5	Applicable documents	5
<b>2</b>	<b>Intended use</b>	<b>5</b>
<b>3</b>	<b>Safety</b>	<b>5</b>
3.1	General safety information	5
3.2	Personal protective equipment	6
<b>4</b>	<b>Necessary tools</b>	<b>6</b>
<b>5</b>	<b>System overview</b>	<b>7</b>
5.1	System description	7
<b>6</b>	<b>Mount the system</b>	<b>10</b>
6.1	Mount rung MS4022 onto rung seat SA/SAA	11
6.2	Mount rung seat SA to IS 8 support	12
6.3	Mount rung seat SAA to steel girder	12
6.4	Mount rung CK/CKD/WSK to IS 8 support or vertical ladder SLS	13
6.5	Mount vertical ladder SLS 80 or IS 8 support to the floor using fastening bracket BW	15
6.6	Mount vertical ladder SLS 80 or IS 8 support to the floor using head plate KL 8	16
6.7	Mount vertical ladder SLS 80 or IS 8 support to the wall using a fastening bracket	17
6.8	Connect vertical ladder SLS 80 with I support connector VIS 8	18
6.9	Mount vertical ladder SLM 50 to the floor	19
6.10	Connect vertical ladder SLM 50 with U support connector VUS 5	22
6.11	Mount vertical ladders SLL 60 and LG 60 to the wall	23
<b>7</b>	<b>Include system in equipotential bonding</b>	<b>25</b>
<b>8</b>	<b>Maintaining the system</b>	<b>25</b>
<b>9</b>	<b>Dismantling the system</b>	<b>26</b>
<b>10</b>	<b>Disposing of the system</b>	<b>26</b>
<b>11</b>	<b>Technical data</b>	<b>26</b>

# 1 About these instructions

## 1.1 Target group

These mounting instructions are intended for the following target group:

- Engineers and architects charged with the planning of vertical ladder systems.
- Electrically trained specialists charged with installing vertical ladder systems.



## 1.2 Relevance of these instructions

These instructions are based on the standards valid at the time of compilation (April 2026).

Please read the instructions carefully before commencing mounting. We will not accept any warranty claims for damage and liability caused through non-observance of these instructions.

Any images are intended merely as examples. Mounting results may look different.

In these instructions, cables and lines are referred to simply as cables.



## 1.3 Types of warning information



---

### Type of risk!

Shows a risky situation. If the warning information is not observed, then serious or fatal injuries may occur.

---

---



---

### Type of risk!

Shows a risky situation. If the warning information is not observed, then medium or minor injuries may occur.

---

---

**ATTENTION**

---

### Type of risk!

Shows a risky situation. If the warning information is not observed, then damage to the product or the surroundings may occur.

---

### Note!

*Indicates important information or assistance.*

## 1.4 Basic standards and regulations

The vertical ladder system fulfils the requirements of DIN EN 61537 VDE 0639:2007-09 – Cable management – Cable tray systems and cable ladder systems.

## 1.5 Applicable documents

The declarations of conformity are linked to the respective products at [www.obo-bettermann.com](http://www.obo-bettermann.com).

The mounting instructions for different clamp clip systems are linked to the respective products at [www.obo-bettermann.com](http://www.obo-bettermann.com).

Surveys and mounting instructions for vertical ladders with maintenance of electrical function:

- [https://api.production.obo.digital/v1/asset/AHQ99J714VL947Caspt-dtv/05-200\\_GS-IBB\\_GA-2023-056-Nau.pdf](https://api.production.obo.digital/v1/asset/AHQ99J714VL947Caspt-dtv/05-200_GS-IBB_GA-2023-056-Nau.pdf)
- [https://api.production.obo.digital/v1/asset/DWh-Y4onaQT8lvhVpK-pX-c/05-200\\_GS-MPA-BS\\_2401-809-22-CM.pdf](https://api.production.obo.digital/v1/asset/DWh-Y4onaQT8lvhVpK-pX-c/05-200_GS-MPA-BS_2401-809-22-CM.pdf)
- [www.obo.de/out/media/05-200\\_H%C3%A4ngende%20Steigetrassen%20im%20Funktionserhalt%20SLM50\\_DE.pdf](http://www.obo.de/out/media/05-200_H%C3%A4ngende%20Steigetrassen%20im%20Funktionserhalt%20SLM50_DE.pdf)
- [www.obo.de/out/media/05-200\\_MA\\_Zugentlastung\\_ZSE90\\_DE.pdf](http://www.obo.de/out/media/05-200_MA_Zugentlastung_ZSE90_DE.pdf)

## 2 Intended use

The vertical ladder systems are used for the vertical support and routing of all kinds of cables, taking the approved load values into account. Depending on the corrosion protection used, they can be used indoors and outdoors. The vertical ladder systems are not designed to support people.

The vertical ladder systems are suitable for use at ambient temperatures of  $-20\text{ °C}$  to  $+120\text{ °C}$ . At temperatures below  $-20\text{ °C}$ , the material will become brittle and may not be processed any further.

The vertical ladder systems are not designed for any purpose other than the one described here. If the vertical ladder systems are used for another purpose, then this shall render all liability, warranty and replacement claims null and void.

## 3 Safety

### 3.1 General safety information

Observe the following general safety information:

- Only have electrical work carried out by specialist personnel with electrical training.
- Risk of cutting from plate edges. Wear protective gloves.
- Design the vertical ladder systems according to the loads to be expected.
- If necessary, include the vertical ladder systems in the equipotential bonding.

### 3.2 Personal protective equipment

List of personal protective equipment to be used:



Use hand protection



Wear safety shoes



Wear head protection



Wear a harness

## 4 Necessary tools

List of tools to be used:

- Angle grinder
- Deburring tool
- Hammer drill
- Drill, metal drill
- Torque spanner
- Screwdriver
- Folding ruler
- Pencil
- Tool to draw on angles

## 5 System overview

### 5.1 System description

The vertical ladder systems include light-duty and heavy-duty vertical ladders, industrial vertical ladders and lightweight cable ladders. Various components are used to create individual vertical ladders and to fasten vertical ladders to the floor, wall, ceiling and steel girders, and also free-standing structures.

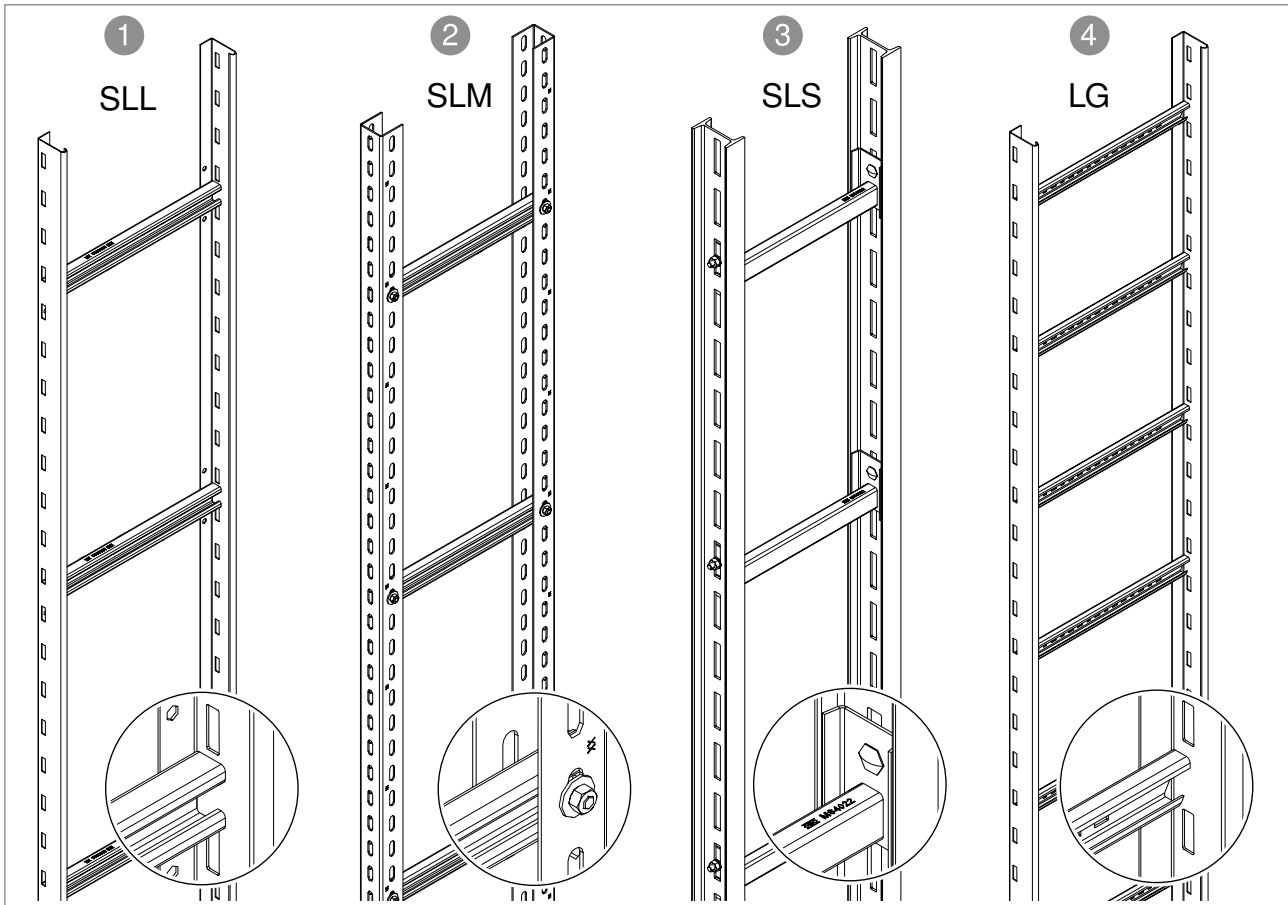

**Abb. 1:** Overview of vertical ladders

- ① Medium-duty vertical ladder SLL, with riveted C profile rung MS4022
- ② Heavy-duty vertical ladder SLM, with bolted C profile rung MS4022
- ③ Industrial vertical ladder SLS, with bolted C profile rung MS4022
- ④ Light-duty vertical ladder LG, with riveted C profile rung MS4022

### Individual vertical ladder components and accessories

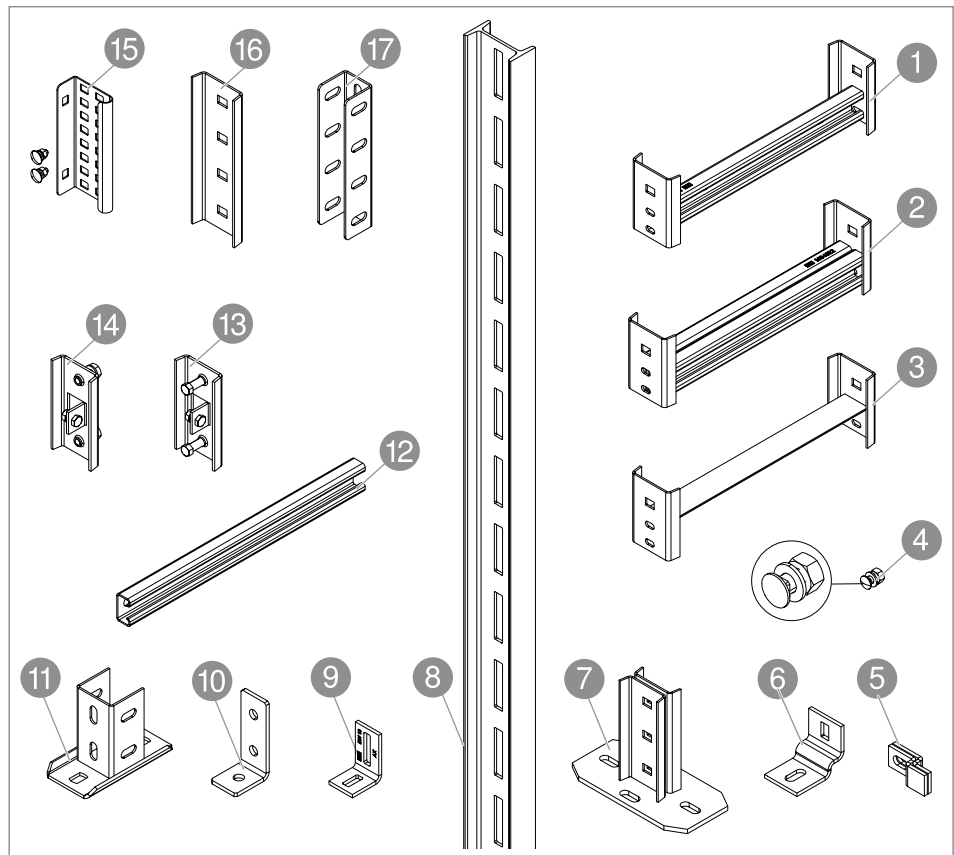

**Abb. 2:** Individual vertical ladder components and accessories

	Designation	Type	Function
①	Rung for IS 8 support	CK 40 FT	Mounting to industrial vertical ladders SLS and IS 8 supports
②	Rung for IS 8 support	CKD 40 FT	Mounting to industrial vertical ladders SLS and IS 8 supports
③	Angle profile rung for IS 8 support	WSK 40 FT	Mounting to industrial vertical ladders SLS and IS 8 supports
④	Truss-head bolt with nut and washer	FRS 10x25 F	Fastening of rungs, connectors, head plates and brackets to supports
⑤	Wall bracket	WB 30 75 FT/A2	Fastening of light-duty vertical ladder SLL to concrete walls and masonry
⑥	Fastening bracket	BW 80 55 FT	Fastening of IS 8 support and vertical ladders SLL and SLS to the wall and floor
⑦	Head plate	KL8 FT	Fastening of IS 8 support and vertical ladders SLS to the floor
⑧	IS 8 support various lengths	IS 8 .. FT	Creation of a vertical ladder in connection with rungs MS4022 and rung seats SA MS4022
⑨	Fastening bracket	BW 10 FT BW 12 FT	Fastening of vertical ladder SLM to the floor
⑩	Mounting bracket	GMS 3 VW 90 FT	Fastening of vertical ladder SLM to the floor
⑪	Head plate	KUS 5 NOK FT/ A2	Fastening of vertical ladder SLM to the floor
⑫	C profile rung	MS4022	Mounting of a vertical ladder in connection with rung seat SA to IS 8 supports or SAA to steel girders
⑬	Rung seat, bolt with coned point M10 x 25 and M8 x 16	SAA MS4022 FT	Fastening of rungs MS4022 to steel girders
⑭	Rung seat, with hexagonal bolt M10 x 30 and M8 x 16	SA MS4022 FT	Fastening of rungs MS4022 to IS 8 supports
⑮	Straight connector	LVG 60 FT	Straight connection of vertical ladders SLL
⑯	I support connector	VIS 8 FT	Straight connection of I supports and vertical ladders SLS
⑰	U support connector	VUS 5 FT	Straight connection of vertical ladders SLM

**Tab. 1:** Individual components and accessories

## 6 Mount the system

Vertical ladders can also be used for maintenance of electrical function. Mounting for the maintenance of electrical function is not part of these mounting instructions. This is described in separate mounting instructions and corresponding surveys, see chapter „1.5 Applicable documents“ on page 5.

The following table shows the required torques for a selection of nuts and bolts. Refer to the OBO fastening material catalogue for the resistance grades of the supplied bolts.

Thread	Tightness class 5.6	Tightness class 8.8
	Friction coefficient 0.14	Friction coefficient 0.14
M6	4.8 Nm	11.3 Nm
M8	11.6 Nm	27.3 Nm
M10	23.1 Nm	54.0 Nm
M12	40.4 Nm	93.0 Nm
M14	64.7 Nm	148.0 Nm
M16	100.7 Nm	230.0 Nm

**Tab. 2:** Tightening torques of bolts with metric thread

Thread	Resistance class 70	Resistance class 80
	Friction coefficient 0.20	Friction coefficient 0.20
M6	9.7 Nm	12.9 Nm
M8	23.6 Nm	31.5 Nm
M10	46.8 Nm	62.4 Nm
M12	81.0 Nm	108.0 Nm
M14	129.0 Nm	172.0 Nm
M16	201.0 Nm	269.0 Nm

**Tab. 3:** Tightening torques of bolts with metric thread made of stainless steel

## 6.1 Mount rung MS4022 onto rung seat SA/SAA

Individual vertical ladder widths can be created with rung seats SA and SAA. The perforated C profile rail MS4022 can be shortened individually for this purpose. Rung seat SA is intended for mounting to I supports, while seat SAA is designed for mounting to steel girders.

**Note!** *The mounting of rung MS4022 to rung seats SA and SAA is identical. The following shows the mounting of rung seat SA.*

**Note!** *Mounting with other perforated rungs is also possible.*

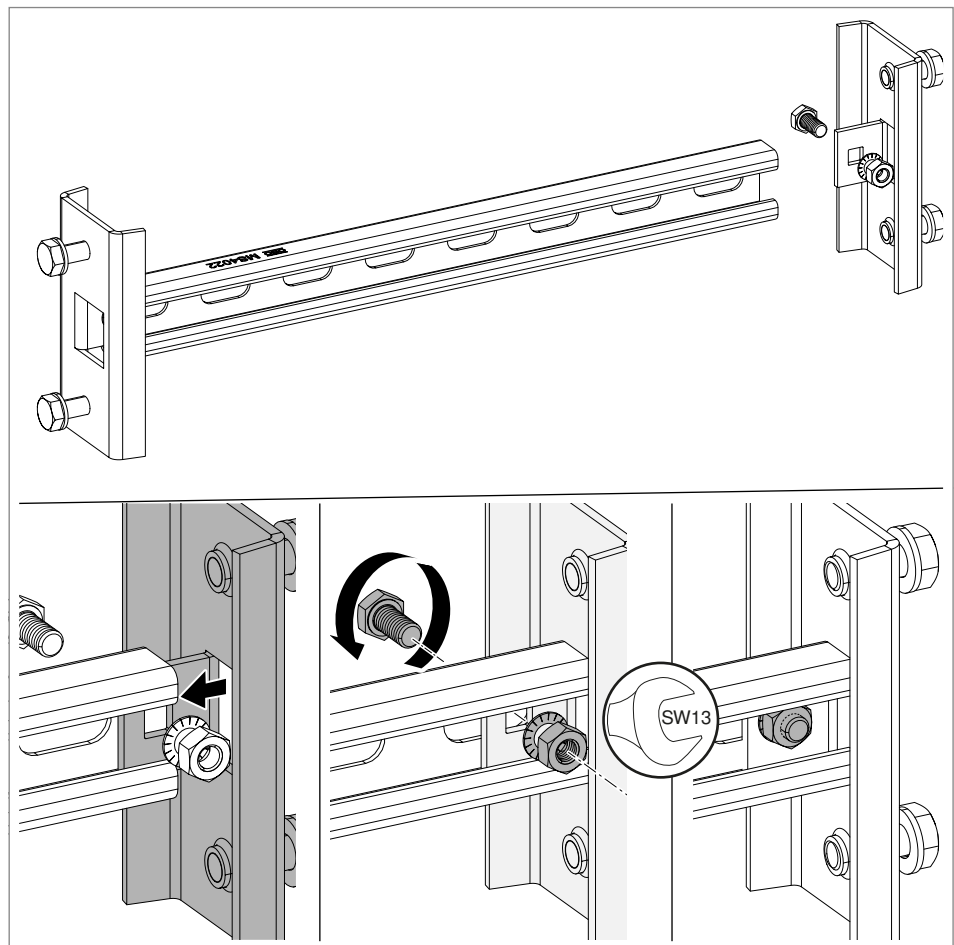

**Abb. 3:** Mount rung MS4022 onto rung seat SA

1. Insert the angled strap of the rung seat into the rung profile.
2. Insert the bolt through the hole on the rung seat and hole on the rung and tighten with a washer and nut.

## 6.2 Mount rung seat SA to IS 8 support

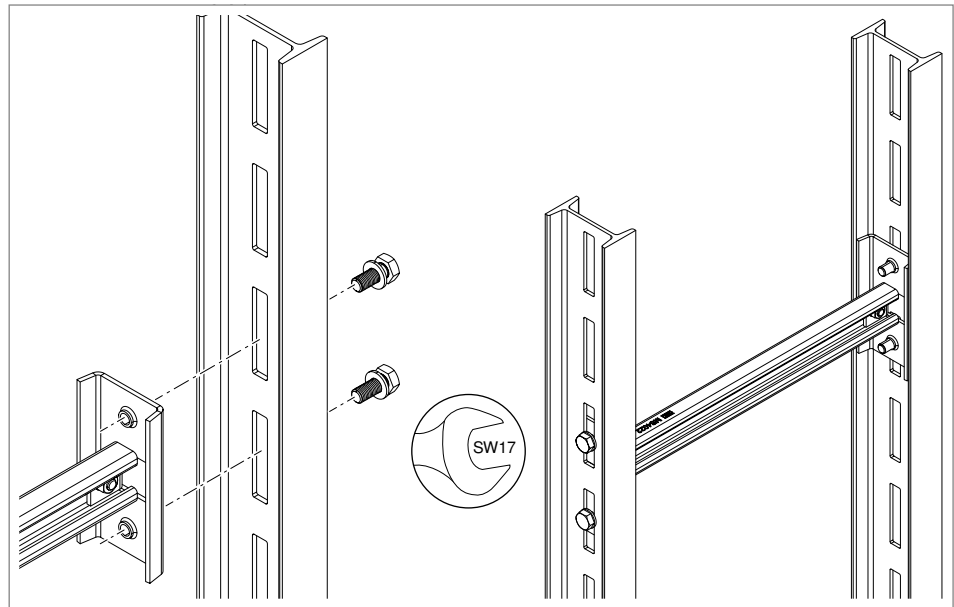

**Abb. 4:** Mount rung seat SA to IS 8 support

1. Insert the hexagonal bolts with washers through the support hole from the outside and screw on the rung seat.

## 6.3 Mount rung seat SAA to steel girder

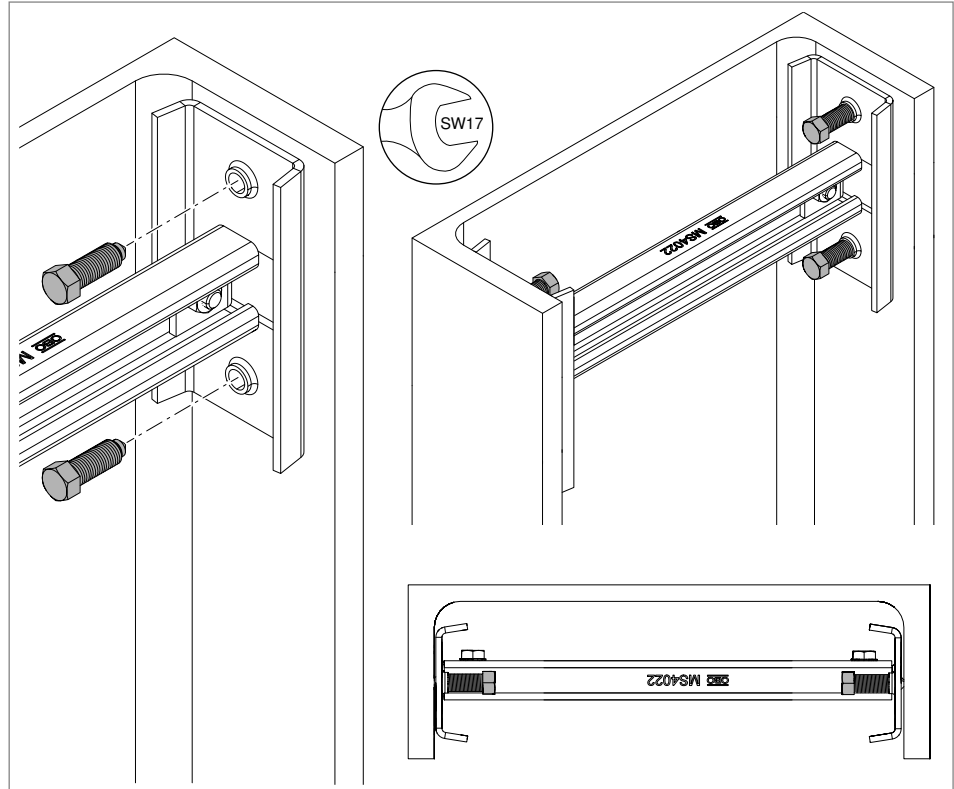

**Abb. 5:** Mount rung seat SAA to steel girder

1. Secure the rung seat to the steel girder from the inside using bolts.

## 6.4 Mount rung CK/CKD/WSK to IS 8 support or vertical ladder SLS

Rungs CK, CKD and WSK together with IS 8 supports can be used to create vertical ladders tailored to individual requirements. The rungs are mounted using truss-head bolts, washers and nuts.

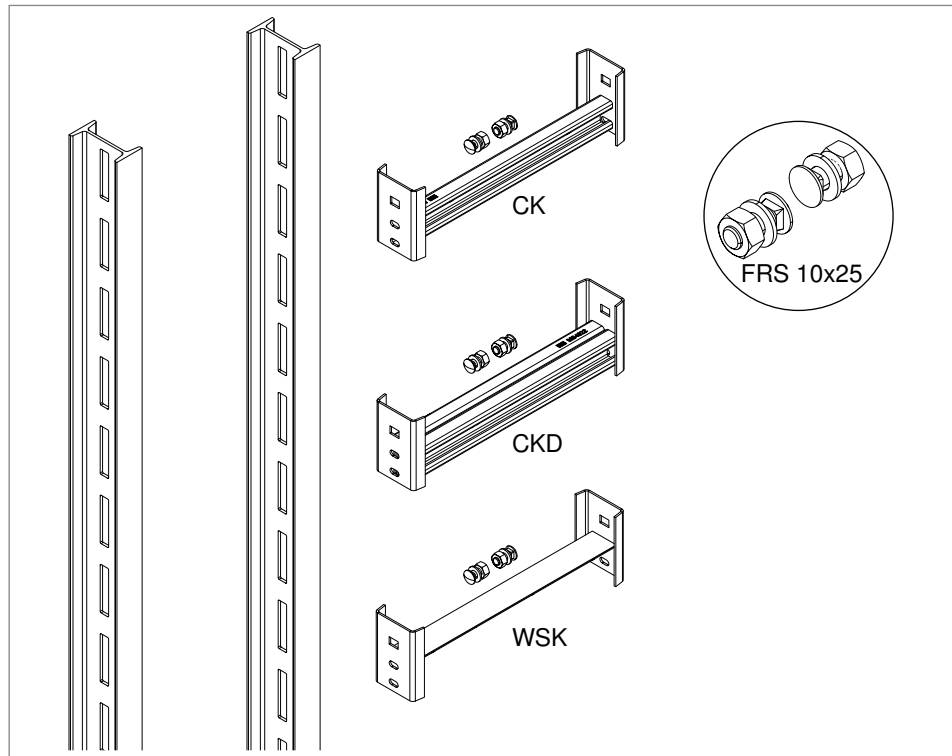

**Abb. 6:** Overview of rungs for IS 8 support

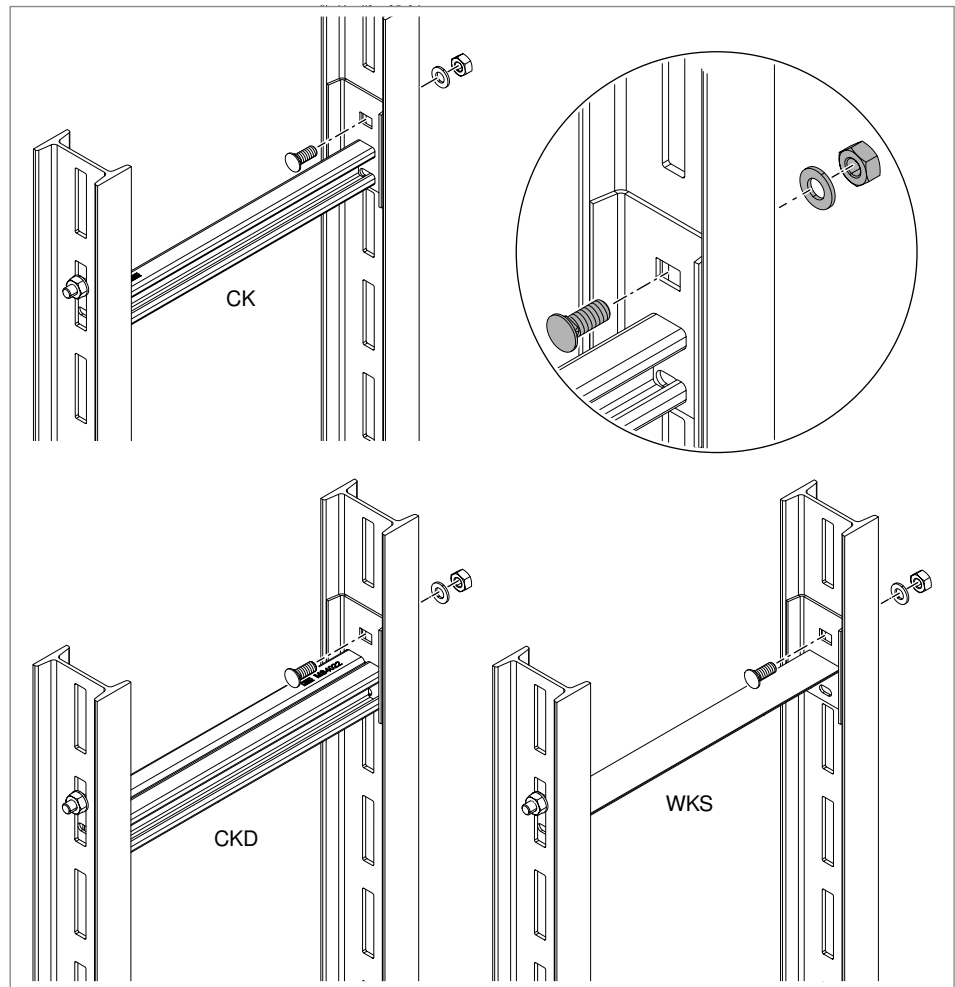

**Abb. 7:** Mount rungs to IS 8 support

1. Screw rungs to IS 8 support from the inside using bolts.

## 6.5 Mount vertical ladder SLS 80 or IS 8 support to the floor using fastening bracket BW

Vertical ladders SLS 80 or the IS 8 support are fastened to the floor using fastening bracket BW. The fastening material for floor mounting depends on the material of the substrate.

**Note!** *If needed, fastening bracket BW can also be used to fasten the SLS 80 to the ceiling.*

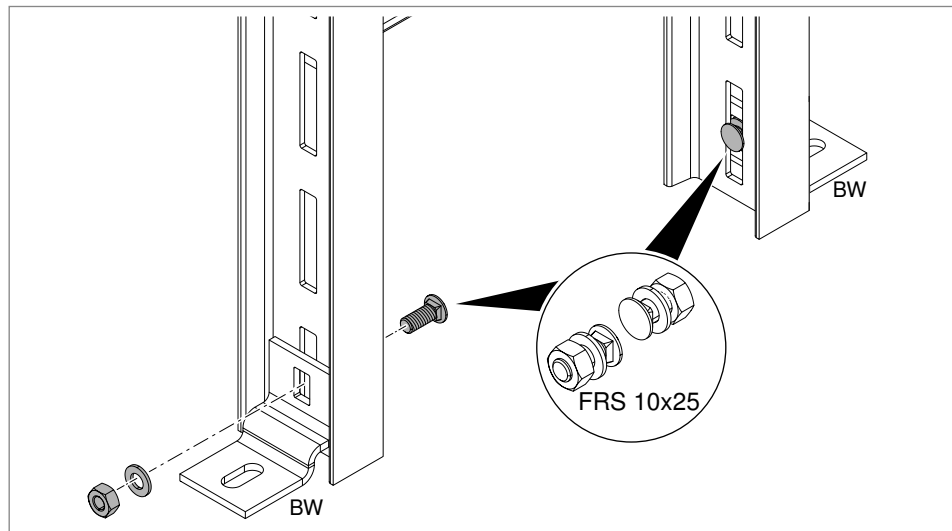

**Abb. 8:** Fasten fastening bracket BW to vertical ladder SLS

1. Fasten fastening bracket BW to the two rails of vertical ladder SLS using bolts, nuts and washers.

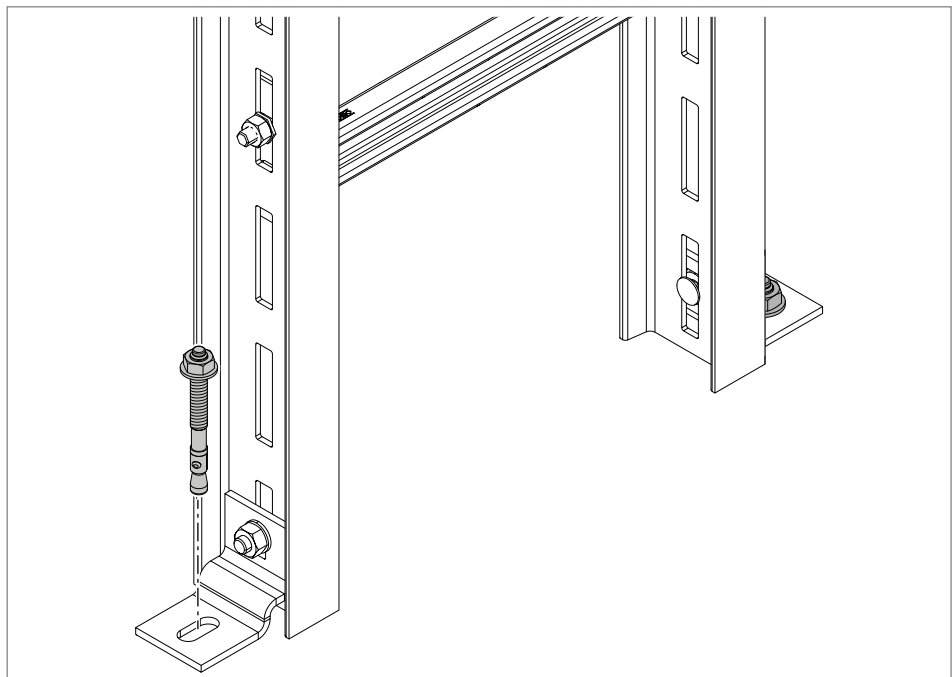

**Abb. 9:** Fasten fastening bracket BW to the floor

2. Fasten vertical ladder SLS or IS 8 support to the floor using suitable fastening material.

## 6.6 Mount vertical ladder SLS 80 or IS 8 support to the floor using head plate KL 8

Vertical ladders SLS 80 or the IS 8 support can also be fastened to the floor using head plate KL 8. The fastening material for floor mounting depends on the material of the substrate.

**Note!** *If needed, head plate KL 8 can also be used to fasten the SLS 80 to the ceiling.*

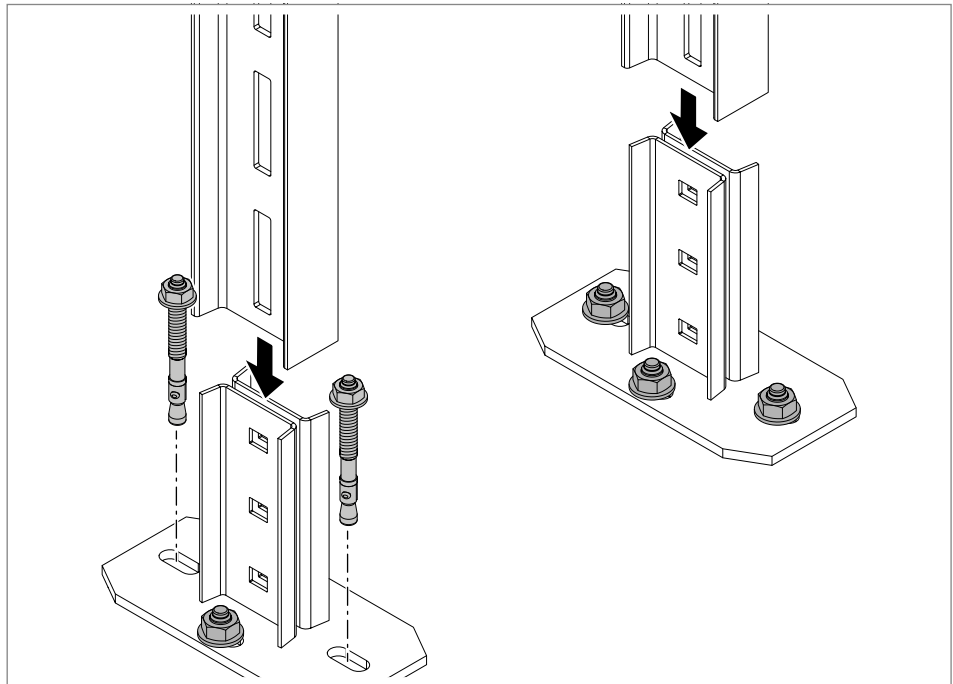

**Abb. 10:** Fasten head plate KL 8 to the floor

1. Fasten head plates KL 8 to the floor using suitable fastening material.
2. Insert vertical ladders or IS 8 supports into the head plates.

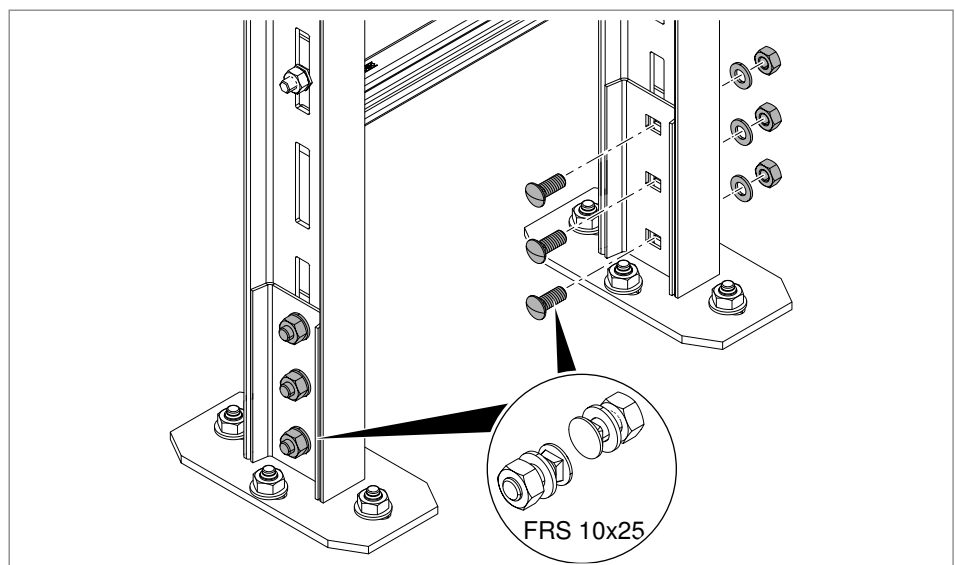

**Abb. 11:** Fasten vertical ladder SLS to head plate

3. Fasten the vertical ladder SLS or IS 8 support to the head plates using bolts, nuts and washers.

## 6.7 Mount vertical ladder SLS 80 or IS 8 support to the wall using a fastening bracket

Vertical ladder SLS 80 or the IS 8 support are fastened to the wall using fastening bracket BW. The fastening material for wall mounting depends on the material of the wall.

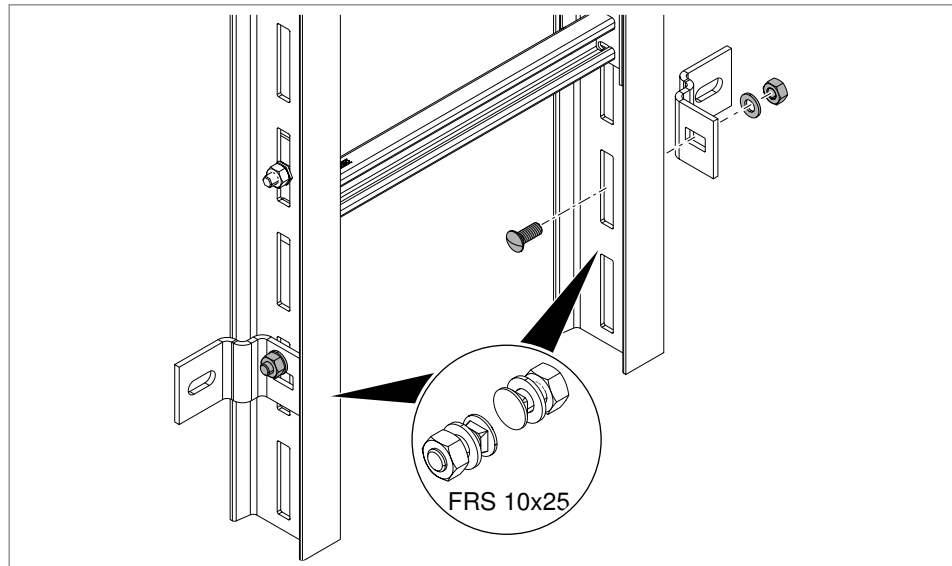

**Abb. 12:** Fasten fastening bracket BW to vertical ladder SLS

1. Fasten fastening bracket BW to the two rails of vertical ladder SLS using bolts, nuts and washers.

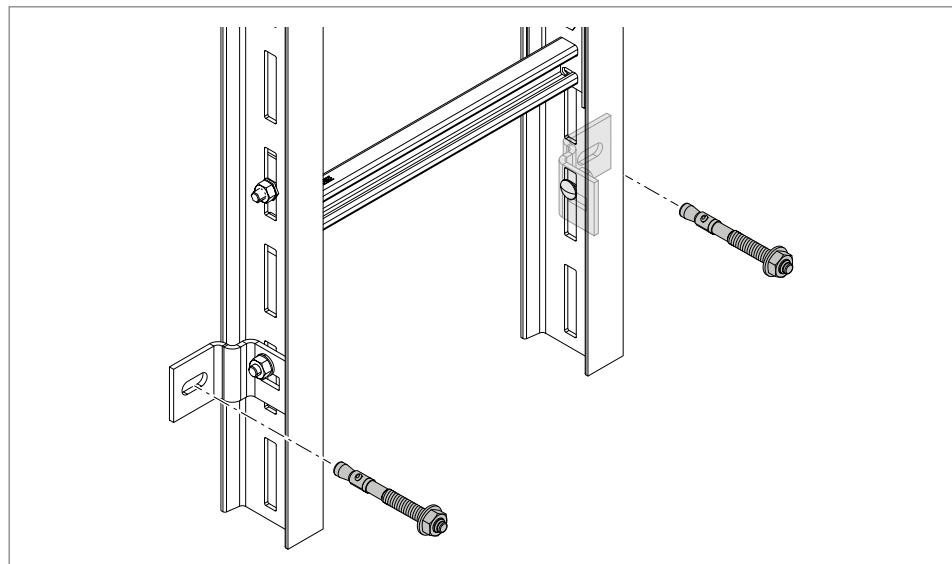

**Abb. 13:** Fasten fastening bracket BW to the wall

2. Fasten fastening bracket BW to the wall using suitable fastening material.

## 6.8 Connect vertical ladder SLS 80 with I support connector VIS 8

Vertical ladder SLS 80 is connected lengthwise to the I support connector type VIS 8 with truss-head bolts, washers and nuts.

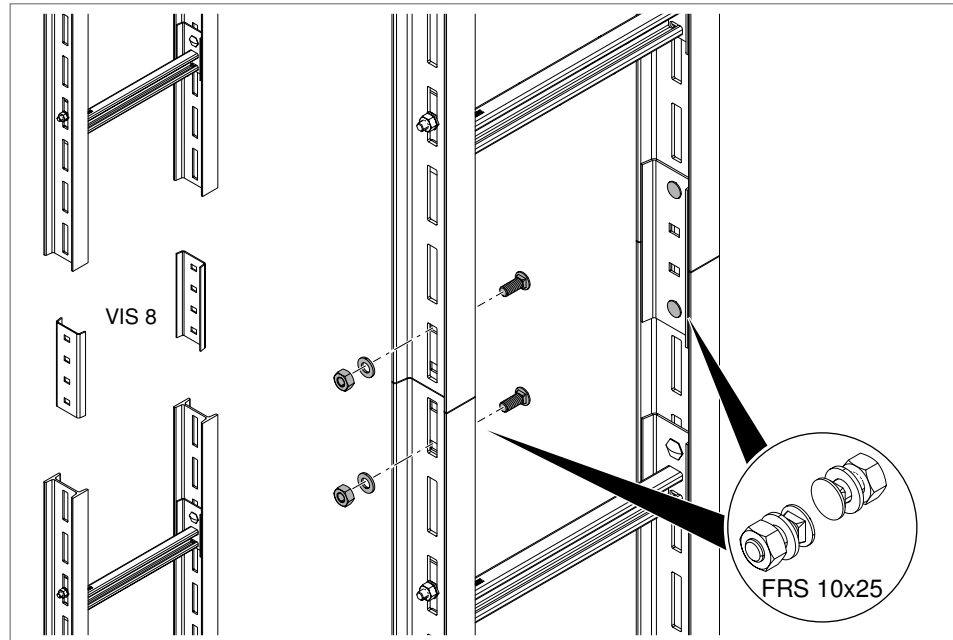

**Abb. 14:** Mount SLS 80 with I support connector VIS 8

1. Place the vertical ladders directly one above the other so that they abut.
2. Insert the I support connectors into the inside of the rail.
3. Insert the truss-head bolts through the straight connector from the inside of the rail.
4. Fasten the I support connector to the vertical ladder rails using bolts, washers and nuts.

## 6.9 Mount vertical ladder SLM 50 to the floor

Vertical ladder SLM 50 is fixed to the floor, for example using fastening brackets, mounting brackets or head plates.

### Mounting with fastening bracket BW10

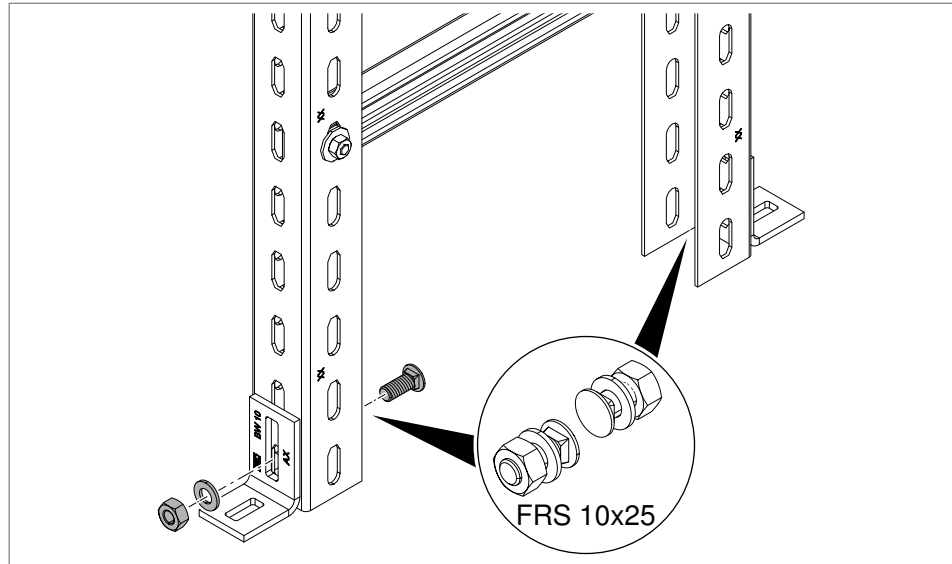

**Abb. 15:** Fasten fastening bracket to vertical ladder SLM

1. Fasten fastening bracket to the two rails of vertical ladder SLM using bolts, nuts and washers.

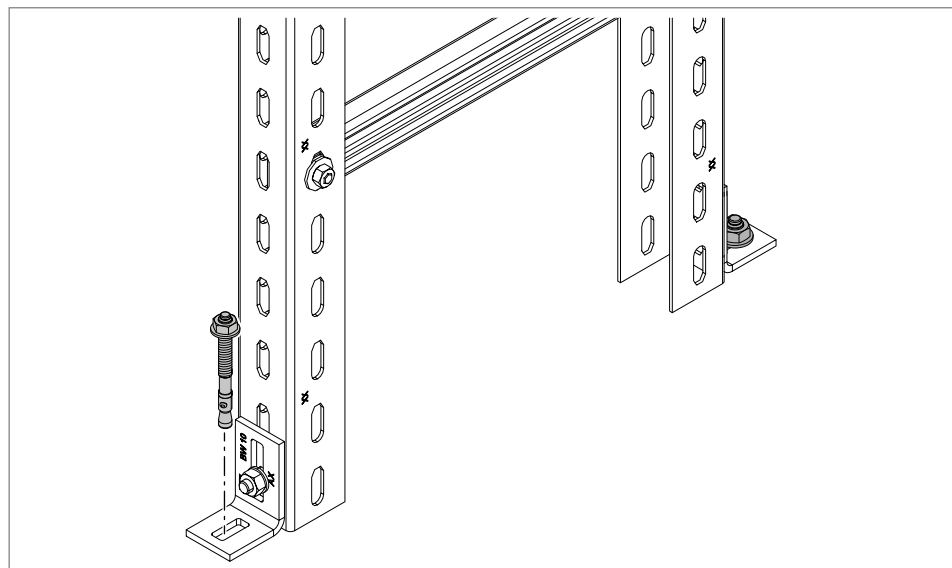

**Abb. 16:** Fasten fastening bracket to the floor

2. Fasten fastening bracket to the floor using suitable fastening material.

### Mounting with mounting bracket GMS

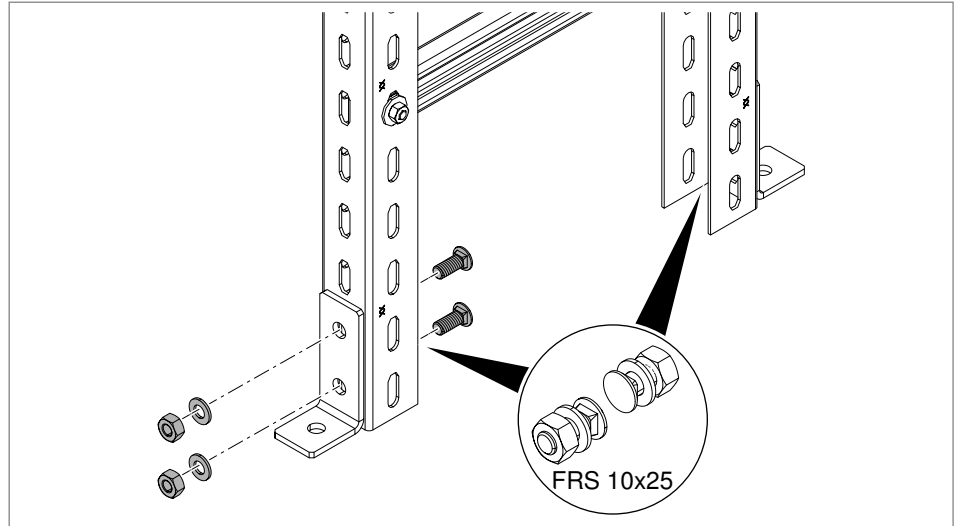

**Abb. 17:** Fasten mounting bracket to vertical ladder SLM

1. Fasten mounting bracket to the two rails of vertical ladder SLM using bolts, nuts and washers.

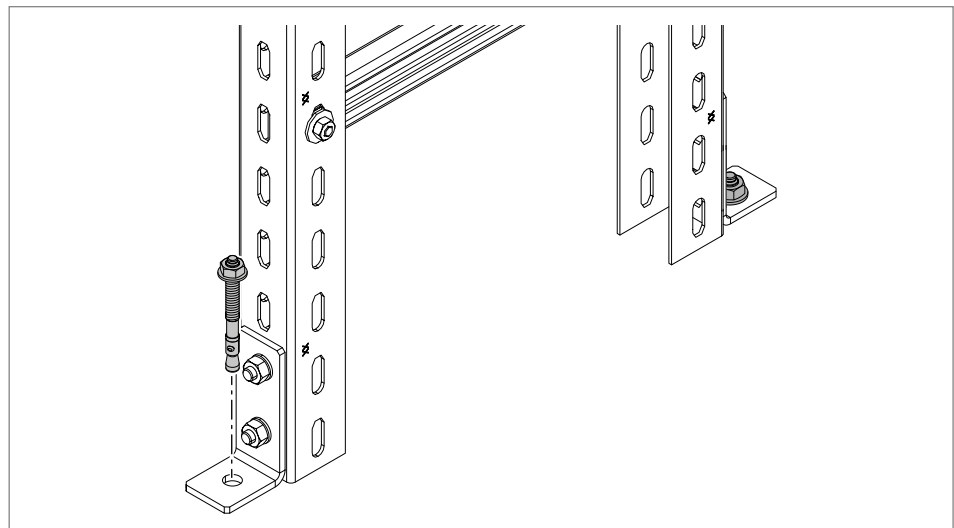

**Abb. 18:** Fasten mounting bracket to the floor

2. Fasten mounting bracket to the floor using suitable fastening material.

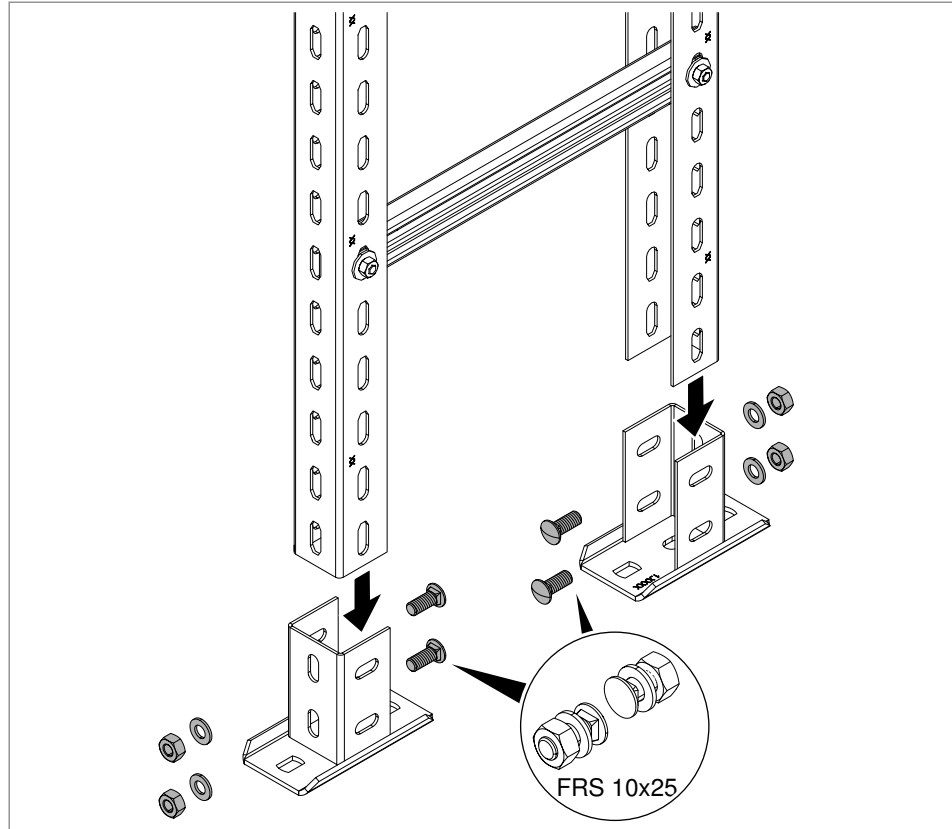
**Mounting with head plate****Abb. 19:** Fasten head plate to vertical ladder SLM

1. Fasten vertical ladder SLM to head plate using bolts, nuts and washers.

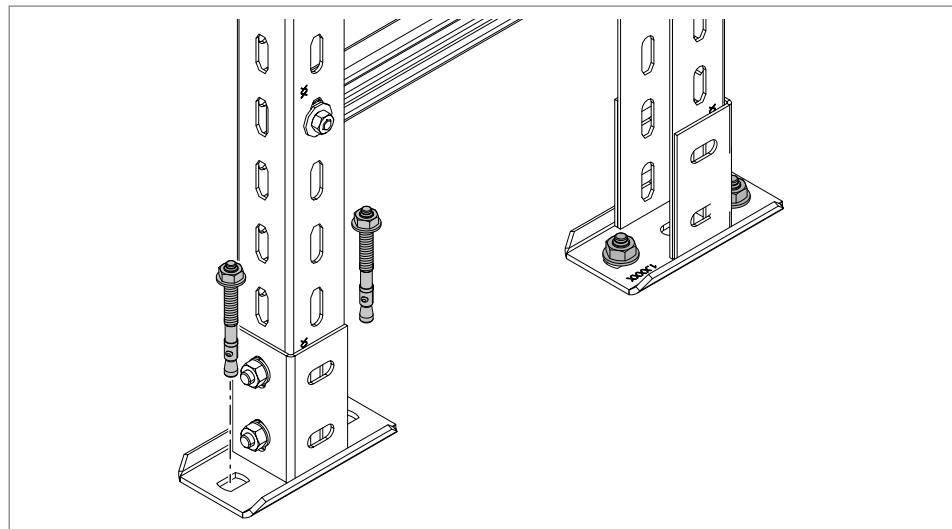
**Abb. 20:** Fasten head plate to the floor

2. Fasten head plate to the floor using suitable fastening material.

## 6.10 Connect vertical ladder SLM 50 with U support connector VUS 5

Vertical ladder SLM 50 is connected lengthwise to the U support connector type VUS 5 with truss-head bolts, washers and nuts.

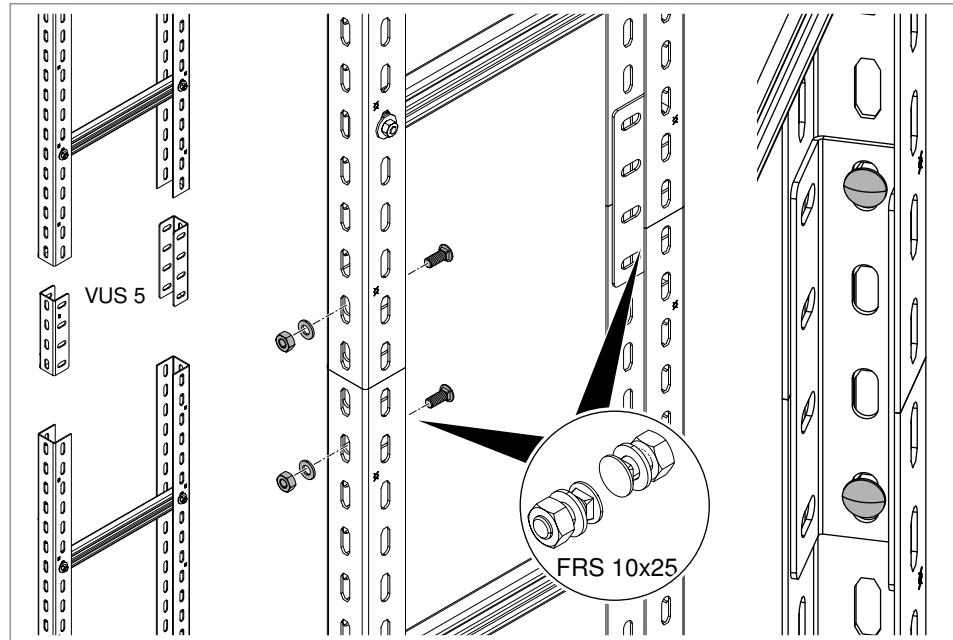

**Abb. 21:** Mount SLM 50 with U support connector VUS 5

1. Place the vertical ladders directly one above the other so that they abut.
2. Insert the U support connector into the inside of the rail.
3. Insert the truss-head bolts through the straight connector from the inside of the rail.
4. Fasten the U support connector to the vertical ladder rails using bolts, washers and nuts.

## 6.11 Mount vertical ladders SLL 60 and LG 60 to the wall

Vertical ladder SLL 60 is mounted to the wall using wall bracket WB or, alternatively, directly to the wall. Cable ladder LG 60 can also be mounted as a vertical ladder in the same way. The fastening material for wall mounting depends on the material of the wall.

### Mount with wall bracket WB

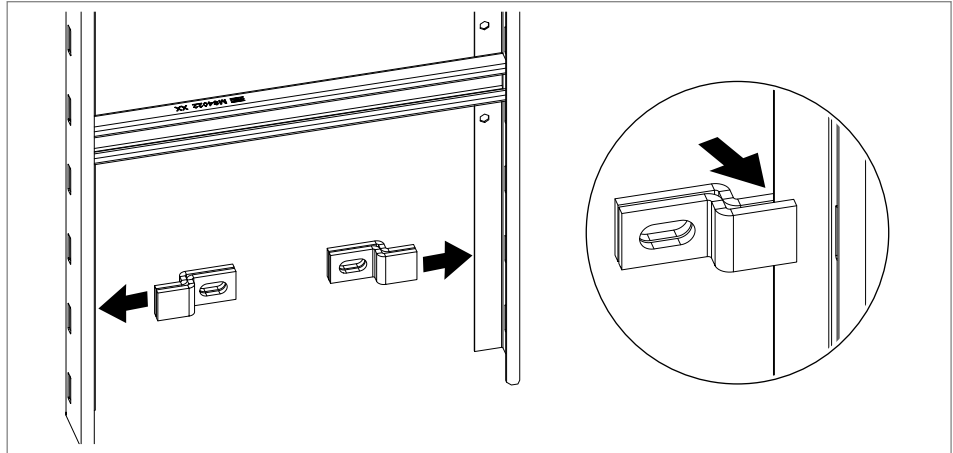

**Abb. 22:** Clamp wall bracket WB to rail

1. Clamp wall bracket WB to vertical ladder rail.

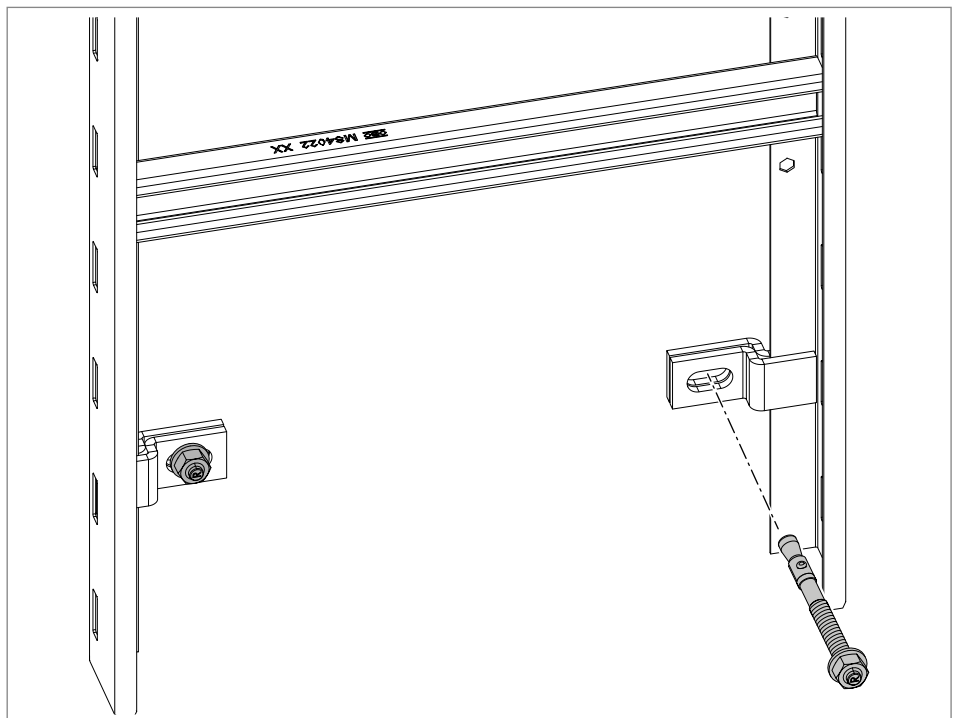

**Abb. 23:** Fasten wall bracket WB with vertical ladder to the wall

1. Fasten wall bracket WB to the wall using suitable fastening materials.

Mounting directly to the wall

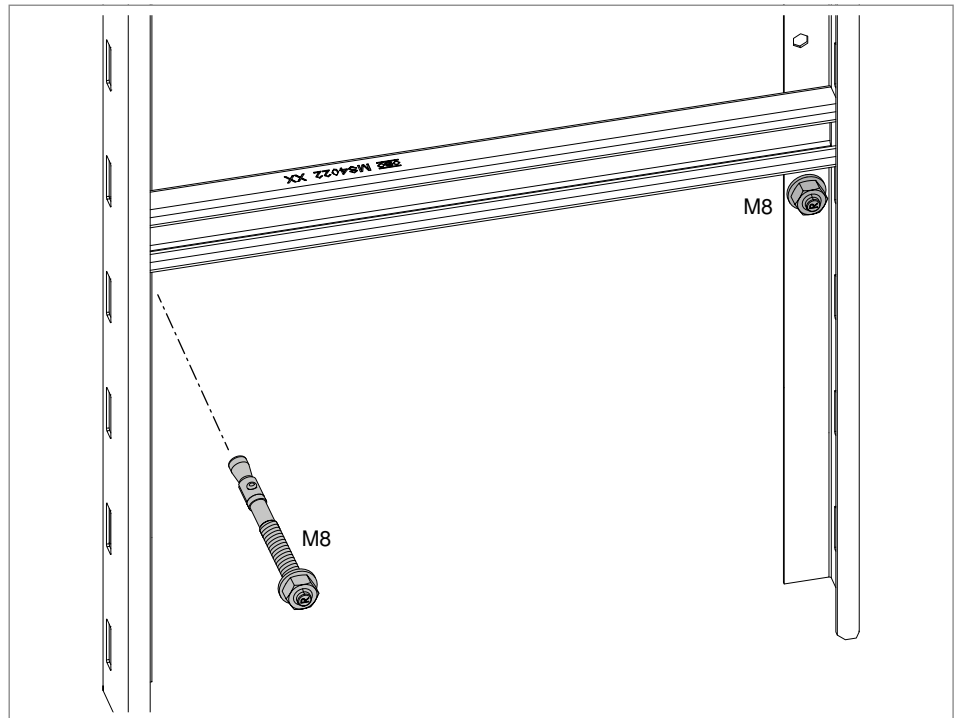

**Abb. 24:** Fasten vertical ladder to the wall

1. Fasten vertical ladder to the wall using suitable fastening materials.

## 7 Include system in equipotential bonding



### Risk of electric shock!

A lack of equipotential bonding can, in cases of damage, mean that parts of the cable ladder system may be energised. If contact creates a conductive connection, this can lead to fatal injuries.

– Create equipotential bonding.

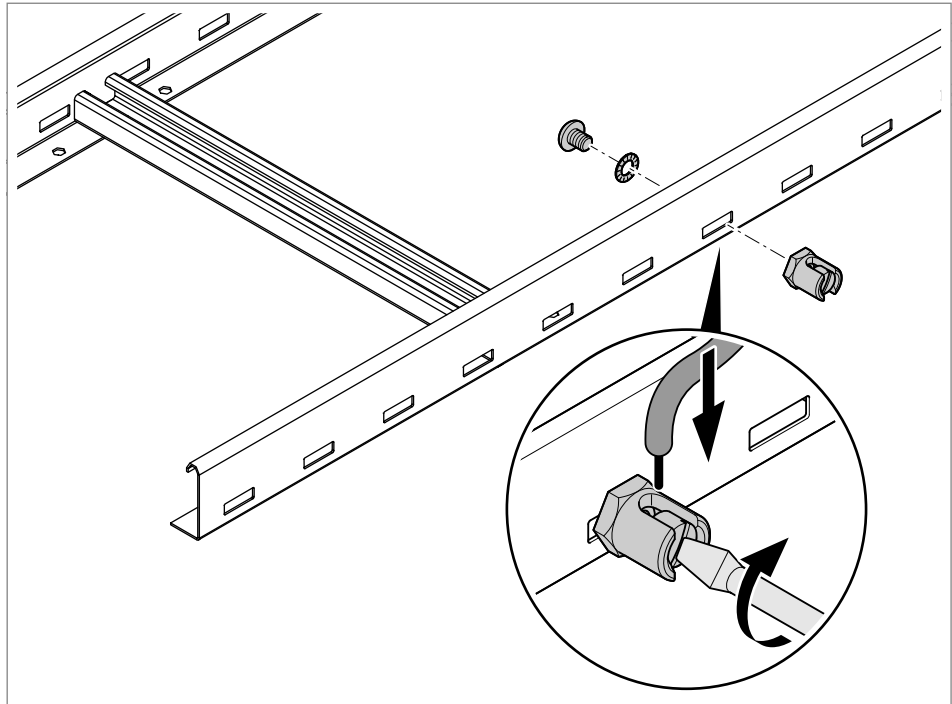

**Abb. 25:** Mounting the earthing terminal

1. Screw the earthing terminal to the rail of the cable ladder.
2. Connect the earthing terminal electrically to the overall equipotential bonding.

## 8 Maintaining the system

The stability and function of vertical ladder systems can be impaired by external influences, such as damage or machine vibrations.

Loose connection elements must be retightened and damaged parts replaced. The connection to the overall equipotential bonding must be continually intact and thus checked regularly.

## 9 Dismantling the system

The dismantling of all the elements of the vertical ladder systems takes place in the reverse order to mounting.

## 10 Disposing of the system



Comply with the local waste disposal regulations.

- Metal: As scrap metal
- Plastic parts: As plastic/...
- Packaging: As household waste/as metal (depending on packaging type)

## 11 Technical data

FS	Strip galvanised steel	A2	Stainless steel, rustproof 1.4301
FT	Hot-dip galvanised steel	A4	Stainless steel, rustproof 1.4571
FT SO	Hot-dip galvanised steel, special coating 85 µm		

### Vertical ladders

Designation	Type	Side height mm	Width mm	Surface	Item no.
Medium-duty vertical ladder	SLL 620 CPS 4 FS	60	200	FS	6010620
Medium-duty vertical ladder	SLL 630 CPS 4 FS	60	300	FS	6010622
Medium-duty vertical ladder	SLL 640 CPS 4 FS	60	400	FS	6010624
Medium-duty vertical ladder	SLL 650 CPS 4 FS	60	500	FS	6010626
Medium-duty vertical ladder	SLL 660 CPS 4 FS	60	600	FS	6010628
Medium-duty vertical ladder	SLL 620 CPS 4 FT	60	200	FT	6010630
Medium-duty vertical ladder	SLL 630 CPS 4 FT	60	300	FT	6010632
Medium-duty vertical ladder	SLL 640 CPS 4 FT	60	400	FT	6010634
Medium-duty vertical ladder	SLL 650 CPS 4 FT	60	500	FT	6010636
Medium-duty vertical ladder	SLL 660 CPS 4 FT	60	600	FT	6010638
Heavy-duty vertical ladder	SLM 50 C40 2 FT	50	200	FT	6010466
Heavy-duty vertical ladder	SLM 50 C40 3 FT	50	300	FT	6010474

Designation	Type	Side height mm	Width mm	Surface	Item no.
Heavy-duty vertical ladder	SLM 50 C40 4 FT	50	400	FT	6010482
Heavy-duty vertical ladder	SLM 50 C40 5 FT	50	500	FT	6010490
Heavy-duty vertical ladder	SLM 50 C40 6 FT	50	600	FT	6010504
Heavy-duty vertical ladder	SLM 50 C40 7 FT	50	700	FT	6010512
Heavy-duty vertical ladder	SLM 50 C40 8 FT	50	800	FT	6010520
Heavy-duty vertical ladder	SLM 50 C40 9 FT	50	900	FT	6010539
Heavy-duty vertical ladder	SLM 50 C40 10 FT	50	1,000	FT	6010547
Heavy-duty vertical ladder	SLM 50 C40 11 FT	50	1,100	FT	6010555
Heavy-duty vertical ladder	SLM 50 C40 12 FT	50	1,200	FT	6010563
Industrial vertical cable ladder	SLS 80 C40 2 FT	80	200	FT	6013384
Industrial vertical cable ladder	SLS 80 C40 3 FT	80	300	FT	6013392
Industrial vertical cable ladder	SLS 80 C40 4 FT	80	400	FT	6013406
Industrial vertical cable ladder	SLS 80 C40 5 FT	80	500	FT	6013414
Industrial vertical cable ladder	SLS 80 C40 6 FT	80	600	FT	6013422
Industrial vertical cable ladder	SLS 80 C40 7 FT	80	700	FT	6013430
Industrial vertical cable ladder	SLS 80 C40 8 FT	80	800	FT	6013449
Heavy-duty vertical ladder	SLS 80 C40 9 FT	80	900	FT	6013457
Heavy-duty vertical ladder	SLS 80 C40 10 FT	80	1,000	FT	6013465
Heavy-duty vertical ladder	SLS 80 C40 11 FT	80	1,100	FT	6013473
Heavy-duty vertical ladder	SLS 80 C40 12 FT	80	1,200	FT	6013481
Industrial vertical cable ladder	SLS 80 W40 4 FT	80	200	FT	6013848
Industrial vertical cable ladder	SLS 80 W40 5 FT	80	300	FT	6013856
Industrial vertical cable ladder	SLS 80 W40 6 FT	80	400	FT	6013864
Industrial vertical cable ladder	SLS 80 W40 7 FT	80	500	FT	6013872
Industrial vertical cable ladder	SLS 80 W40 8 FT	80	600	FT	6013880
Industrial vertical cable ladder	SLS 80 W40 9 FT	80	700	FT	6013899
Industrial vertical cable ladder	SLS 80 W40 10 FT	80	800	FT	6013902

**Rungs**

Designation	Type	Length mm	Rung width x height mm	Slot width mm	Surface	Item no.
Angle profile rung	WSK 40 40 FT	400	40 x 40		FT	6008046
Angle profile rung	WSK 40 50 FT	500	40 x 40		FT	6008054
Angle profile rung	WSK 40 60 FT	600	40 x 40		FT	6008062
Angle profile rung	WSK 40 70 FT	700	40 x 40		FT	6008070
Angle profile rung	WSK 40 80 FT	800	40 x 40		FT	6008089
Angle profile rung	WSK 40 90 FT	900	40 x 40		FT	6008097
Angle profile rung	WSK 40 100 FT	1,000	40 x 40		FT	6008100
C rung for IS 8 support	CK 40 20 FT	200	40 x 22.5	18	FT	6008224
C rung for IS 8 support	CK 40 30 FT	300	40 x 22.5	18	FT	6008232
C rung for IS 8 support	CK 40 40 FT	400	40 x 22.5	18	FT	6008240
C rung for IS 8 support	CK 40 50 FT	500	40 x 22.5	18	FT	6008259
C rung for IS 8 support	CK 40 60 FT	600	40 x 22.5	18	FT	6008267
C rung for IS 8 support	CK 40 70 FT	700	40 x 22.5	18	FT	6008275
C rung for IS 8 support	CK 40 80 FT	800	40 x 22.5	18	FT	6008283
C rung for IS 8 support	CK 40 90 FT	900	40 x 22.5	18	FT	6008291
C rung for IS 8 support	CK 40 100 FT	1,000	40 x 22.5	18	FT	6008305
C rung for IS 8 support	CK 40 110 FT	1,100	40 x 22.5	18	FT	6008313
C rung for IS 8 support	CK 40 120 FT	1,200	40 x 22.5	18	FT	6008321
C rung for IS 8 support	CK 40 40 FT SO	400	40 x 22.5	18	FT SO	7194104
C rung for IS 8 support	CK 40 60 FT SO	600	40 x 22.5	18	FT SO	7194048
C rung for IS 8 support	CK 40 80 FT SO	800	40 x 22.5	18	FT SO	7194109
C rung for IS 8 support	CK 40 100 FT SO	1,000	40 x 22.5	18	FT SO	7194064
C rung for IS 8 support	CK 40 120 FT SO	1,200	40 x 22.5	18	FT SO	7194113
C rung for IS 8 support	CKD 40 60 FT	600	40 x 22.5	18	FT	6008269
C rung for IS 8 support	CKD 40 70 FT	700	40 x 22.5	18	FT	6008277
C rung for IS 8 support	CKD 40 80 FT	800	40 x 22.5	18	FT	6008285
C rung for IS 8 support	CKD 40 90 FT	900	40 x 22.5	18	FT	6008293

**Accessories**

Designation	Type	Length x width x height mm	Surface	Item no.
Rung seat with hexagonal bolts M10x30	SA MS4022 FT	131 x 61	FT	6007496
Rung seat with hexagonal bolts M10x30	SA CPS 4 FT SO	10 x 68	FT SO	7194118
Rung seat, bolt with coned point M10	SAA MS4022 FT	130 x 68	FT	6007498
Profile rail, perforated, slot width 18 mm in lengths from 100 to 6,000 mm	MS4022P...	MS4022P...	FS/FT	1121...
Fastening bracket for IS 8 support	BW 80 55 FT SO	65 x 55 x 80	FT SO	7189168

Designation	Type	Length x width x height mm	Surface	Item no.
Fastening bracket	BW 10 FT	70 x 50 x 40	FT	6019480
			A2	6019484
			A4	6019486
Fastening bracket	BW 12 FT	70 x 50 x 40	FT	6019500
			A2	6019504
			A4	6019506
Mounting bracket	GMS 3 VW FT GMS 3 VW A2	105 x 40 x 53	FT	1124661
			A2	1124701
Wall bracket for vertical ladder fastening	WB 30 75 FT WB 30 75 A2	75 x 30 x 19	FT	6019617
			A2	6019668
Straight connector for cable ladder	LVG 60 FT LVG 60 FT LVG 60 A2 LVG 60 A4	64 x 150	FS	6208840
			FT	6208843
			A2	6208846
			A4	6208835
U support connector, including truss-head bolts	VUS 5 FT VUS 5 A4	46.5 x 44 x 190	FT	6018505
			A4	6018509
I support connector and truss-head bolts	VIS 8 FT	17.5 x 68 x 200	FT	6018300
Head plate for US 8 support, turned 90°	KUS 5 NOK FT KUS 5 NOK A2	140 x 75 x 104	FT	6348939
			A2	6348947
Head plate for IS 8 support	KL 8 FT	200 x 100 x 156.5	FT	6347053

**OBO Bettermann Holding GmbH & Co. KG**  
P.O. Box 1120  
58694 Menden  
GERMANY

**Technical Office**  
Tel.: +49 (0)2373 89-1300

[technical-office@obo.de](mailto:technical-office@obo.de)

[www.obo-bettermann.com](http://www.obo-bettermann.com)

Date 04/2026

251027.02

---

**Building Connections**

